



KEY:

-  EXISTING SYL
-  PROPOSED DYL
-  PROPOSED SYL

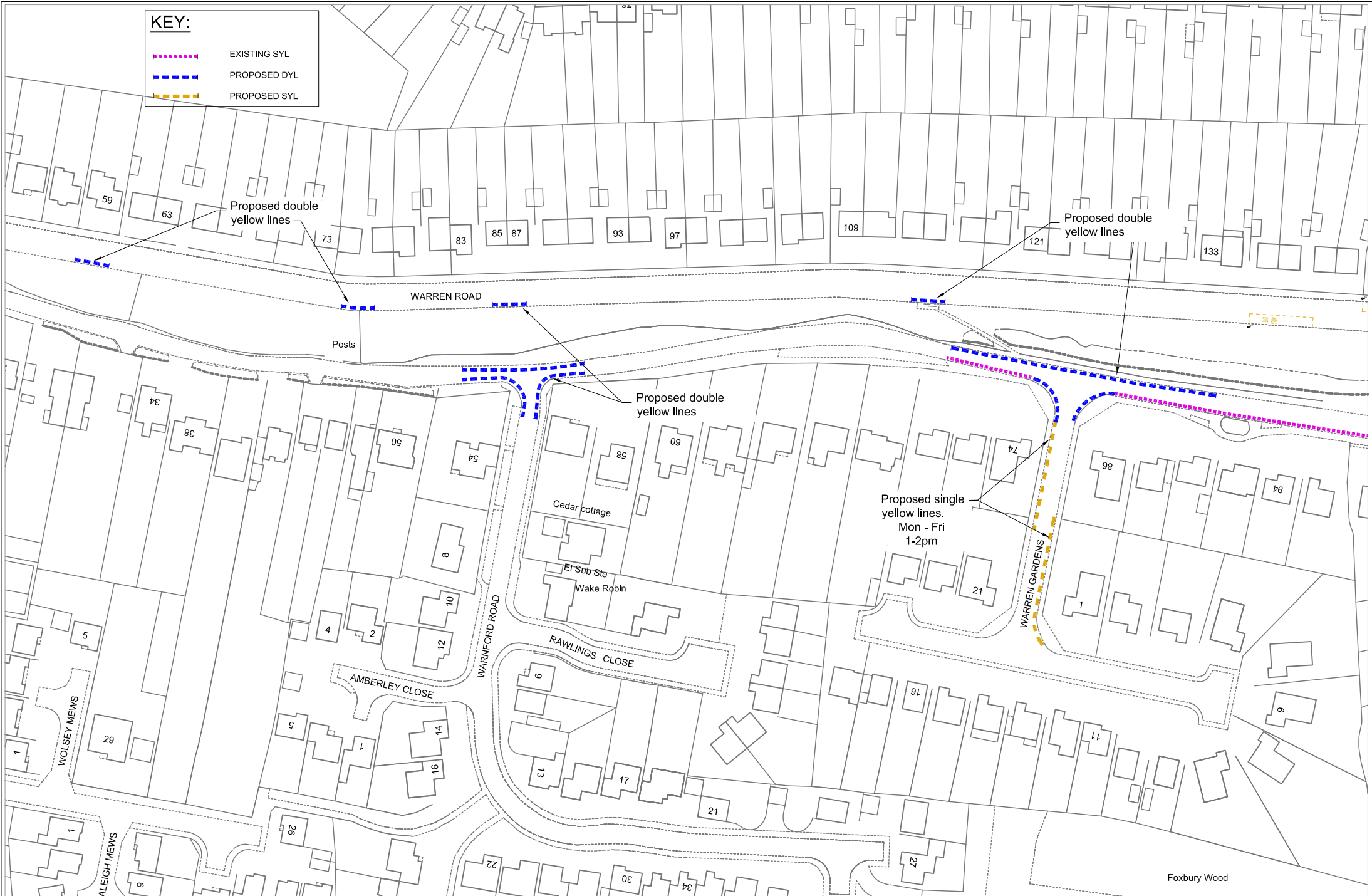

© Crown copyright and database rights 2013 Ordnance Survey 100017661.

Job Title: **CHELSEFIELD AREA PARKING REVIEW**

Drawing Title: **WARREN ROAD EAST,
EXISTING PARKING RESTRICTIONS
AND PROPOSED PARKING AMENDMENTS**



Environmental Services
395 Centre, Sturveston Close,
Boreley, SE8 1JH
Tel: 020 8464 4333
Fax: 020 8191 4865
Email: www.parking@pc.gov.uk

Scale @ A1: 1:500
Date: 21/06/13

| Rev | Date | Description |
|-----|----------|------------------|
| A | 30/07/13 | Minor amendments |

Drawn by: J.J.
Checked by: I.A.

By: J.J.
Rev: A
Drawing Number: 11051-106

Neil Davies
Executive Director of Environment & Community Services